

Shuttle Bus Quote – Skagway School District
2015 Starcraft Prodigy 14 Passenger MFSAB

CHEVROLET PRODIGY MFSAB 4 SECTION 12300 GVWR 6.0L GAS 139"WB	ST	5923	P	C	1
SPECIAL BUILD ORDER					
Add Drop Down Tire Chains	ST	0599			1
RUB RAILS					
APPLIED RUB RAIL - FLOOR LINE	05	STD			1
APPLIED RUB RAIL - SEAT HEIGHT / SEAT HEIGHT WRAPS AROUND REAR OF BUS	05	STD			1
FLOORING					
BLACK RIBBED RUBBER AISLE W/ SMOOTH RUBBER UNDER SEATS	05	STD			1
BLACK RIBBED ENTRY STEPS W/ WHITE STEP NOSING ON ALL STEPS	05	STD			1
INTERIOR					
GRAY VINYL DOOR HEADER AND BULKHEAD PADS	05	STD			1
DRIVER'S STORAGE IN FRONT BULKHEAD AREA WITH LOCK	05	STD			1
CHASSIS					
UNDERCOATING TO OEM CHASSIS SPECIFICATIONS	05	STD			1
DUAL DRIVE SHAFT GUARDS	05	STD			1
FRONT AND REAR MUD FLAPS	05	STD			1
EXTERIOR MIRRORS					
REARVIEW EXTERIOR MIRRORS W/ STREET SIDE & CURBSIDE FRONT MOUNTED CROSSOVER MIRRORS	05	STD			1
ELECTRICAL					
PRINTED CIRCUIT BOARD WITH FUSES MOUNTED IN LOCKABLE COMPARTMENT ABOVE DRIVER DOOR	05	STD			1
CHILD CHECKMATE WITH OPERATING INSTRUCTIONS ABOVE DRIVER	05	STD			1
INTERIOR LIGHTS					
INTERIOR STEP WELL LIGHTS	05	STD			1
EXTERIOR LIGHTS					
LED FRONT AND REAR MARKER LIGHTS	05	STD			1
4" RED LED ROUND REAR STOP LIGHTS (2) - PRODIGY SRW	05	STD			1
4" AMBER ROUND LED REAR TURN LIGHTS (2) - PRODIGY SRW	05	STD			1
7" RED LED ROUND REAR STOP LIGHTS (2) - PRODIGY DRW	05	STD			1
7" AMBER ROUND LED REAR TURN LIGHTS (2) - PRODIGY DRW	05	STD			1
4" ROUND LED BACK-UP LIGHTS (2) - PRODIGY SRW & DRW	05	STD			1
LED SIDE MOUNTED MIDSHIP TURN AND MARKER LIGHTS	05	STD			1
REAR HEATER					
35,000 BTU FLOOR MOUNTED HEATER W/ (1) HEATER SHUT OFF VALVE	05	STD			1
UPGRADE TO 65,000 BTU FLOOR HEATER IN LIEU OF STANDARD 35K W/ (1) HEATER SHUT OFF VALVE	05	5665			1
C.E. WHITE SCHOOL BUS SEATS - 42 oz. VINYL					
DRIVERS SIDE 36" WIDE SCHOOL BUS SEAT - 42 oz. VINYL	05	5030			3
PASSENGER SIDE 36" WIDE SCHOOL BUS SEAT - 42 oz. VINYL	05	5037			4
BARRIER KICK PANELS					

CURBSIDE KICK PANEL BELOW BARRIER	05	STD	1
SEAT BELTS - EACH			
SEAT BELTS - EACH	05	STD	1
EXTERIOR SAFETY			
BACK-UP ALARM 97 DB	05	STD	1
INTERIOR SAFETY			
2.5 LB FIRE EXTINGUISHER	05	STD	1
16 UNIT FIRST AID KIT	05	STD	1
BODILY FLUIDS KIT	05	STD	1
EMERGENCY TRIANGLE KIT W/ RED STORAGE BOX	05	STD	1
SEAT BELT CUTTER	05	STD	1
INTERIOR MIRROR 6" X 16"	05	STD	1
DOORS			
REAR EXIT DOOR W/ UPPER & LOWER GLASS, DOOR AJAR BUZZER, RED INTERIOR LIGHT ABOVE REAR DOOR, LOCKING FLOOR MOUNTED HOLD OPEN DEVICE, HEAVY DUTY GREASE ABLE HINGES, RED EMERGENCY DOOR HANDLE, INTERIOR, 3-POINT LATCH	05	STD	1
(2) WINDOWS EACH SIDE OF REAR EXIT DOOR	05	STD	1
REAR DOOR STARTER INTERRUPT WITH VANDAL LOCK WITH BUZZER	05	STD	1
ELECTRIC BI-FOLD ENTRY DOOR WITH UPPER AND LOWER EMERGENCY RELEASE HANDLES	05	STD	1
ENTRY DOOR HAND RAILS			
LEFT HAND MOUNTED FULL LENGTH ENTRY DOOR GRAB RAIL	05	STD	1
WINDOWS			
TINTED SPLIT SASH PASSENGER WINDOWS WITH BLACK FRAME	05	STD	1
DECALS			
WHITE REFLECTIVE PRISMATIC EXTERIOR TAPE OUTLINING ALL EMERGENCY EXITS	05	STD	1
DECAL "EMERGENCY DOOR" RED INTERIOR AND BLACK EXTERIOR	05	STD	1
DECAL "HEATER VALES" WITH ARROWS MOUNTED ON BODY CLOSE TO VALVE LOCATION	05	5243	1
WARRANTY			
3 YEAR / 36,000 MILE BUMPER TO BUMPER WARRANTY	05	STD	1
5 YEAR / 60,000 MILE STRUCTURAL WARRANTY	05	STD	1

Total Cost Per Unit After Rebates: \$49,049

Delivery to Skagway Port: \$2,672

Total Cost: \$51,721

A 10% non-refundable down payment is required at time of order.

Balance Due Upon Delivery. Price Quote Valid Until 7/15/2015

Customer Signature _____ Date _____

Northwest Bus Signature _____ Date _____

Quote Provided by Erick Vandersnick

Email: erick@nwbus.com

Phone: 800.231.7099

DEALER APPROVAL

APPROVED

CUSTOMER SIGNATURE

FLOORPLAN SHOWS LOCATION OF OPTIONAL ROOF HATCH AND EGRESS WINDOWS. SEE SALES ORDER FOR INFORMATION.

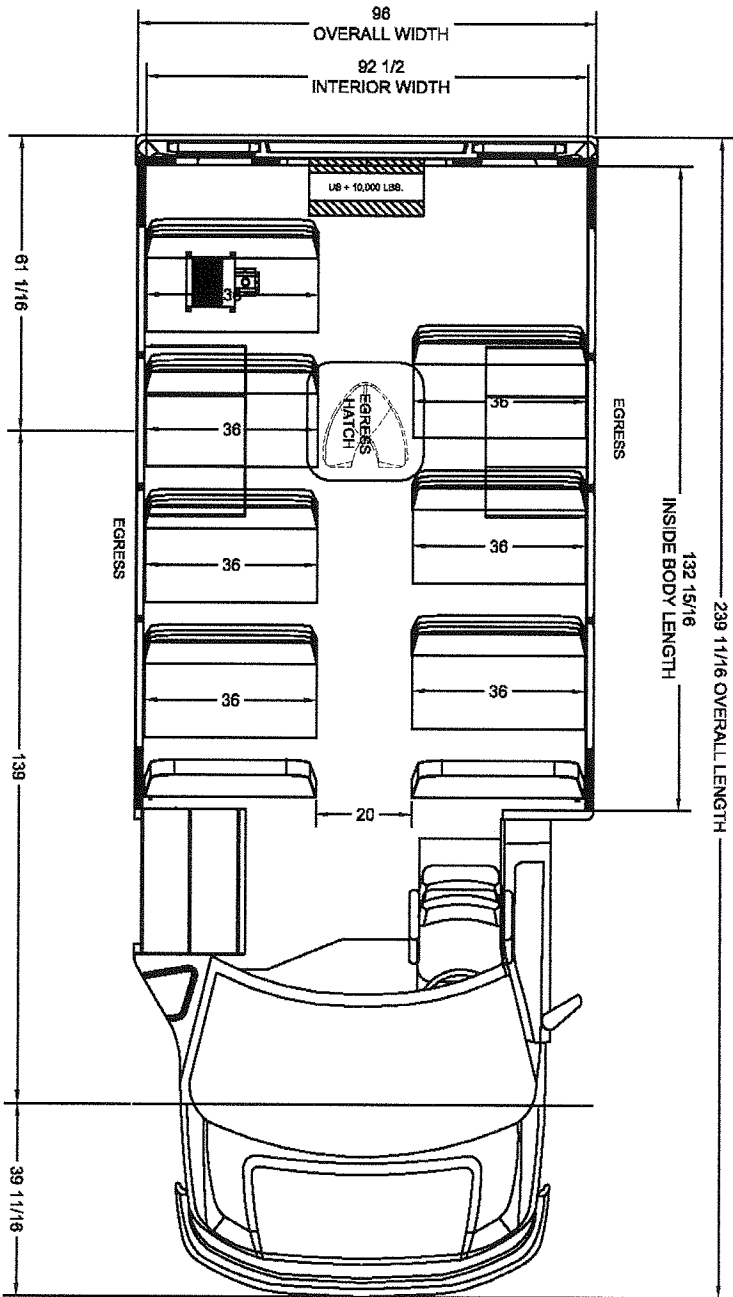

SEATED	W/C
14	-
SEAT SPACINGS:	R28" L30"
14	14
KNEE SPACINGS:	R23" L25"
14	PASSENGER CAP: 14

THIS DRAWING AND THE INFORMATION THEREON ARE THE EXCLUSIVE PROPERTY OF STARCRAFT BUS, A DIVISION OF FOREST RIVER. IT SHALL NOT BE COPIED OR REPRODUCED IN ANY MANNER, NOR SHALL IT BE SUBMITTED TO OUTSIDE PARTIES FOR EXAMINATION WITHOUT OUR WRITTEN CONSENT. IT IS LOANED FOR USE WITH REFERENCE TO WORK UNDER CONTRACT WITH, OR PROPOSALS SUBMITTED TO STARCRAFT BUS, A DIVISION OF FOREST RIVER.

REV.	DESCRIPTION OF CHANGE	BY	CHK	DATE	EON No.

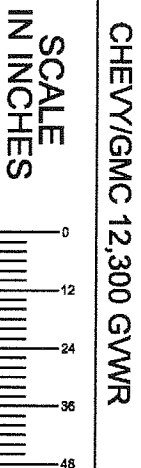

TOLERANCE UNLESS OTHERWISE SPECIFIED

WOOD ± 1/8"

OTHER ± 1/16"

DATE: 4/29/11

NAME: V/C

DWG No. 31-91-A-112

STARCRAFT BUS

division of Forest River, Inc.

139" WHEEL BASE - 4 SECTION DUAL WHEEL PRODIGY STANDARD FLOOR

DESCRIPTION OF CHANGE

BY

CHK

DATE

EON No.

± 1"

± 1/2"

NAME: V/C

DWG No. 31-91-A-112

SHEET 1 OF 3